

1. Camera

Product picture for reference only, specific product in kind prevails.

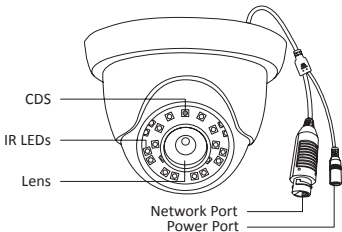

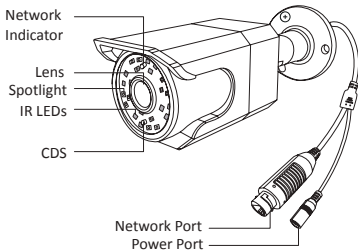

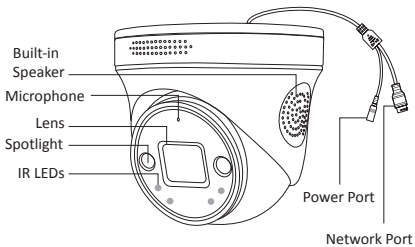
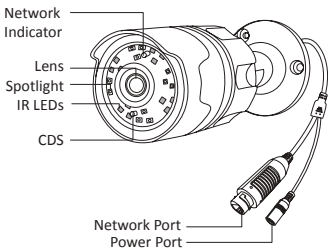
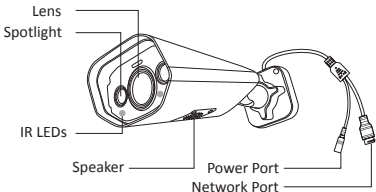

2. Install the Camera

- ① Attach the mounting template, drill screw holes on the wall according to the mounting template, and insert rubber plugs into the holes.
- ② Align the camera with the rubber plugs on the wall, and use a screwdriver(not included) to screw into the rubber plugs.
- ③ Adjust the camera to a proper angle and screw the bracket.

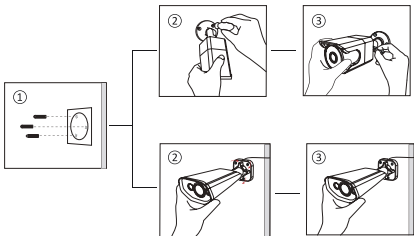

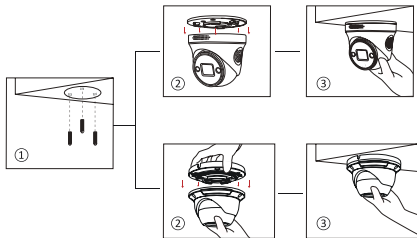

3. Connect the System

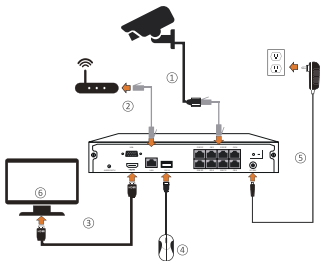

Product picture for reference only, specific product in kind prevails.